

Ericsson AXE-10 IOG11 Solid State Optical Disk Drive Replacement Procedure

(Applies to Optical Disk Drive Module # ROD 907 32)



The procedure on the following pages details removing the failing Optical Disk Drive on an Ericsson AXE-10 Module & replacing it with a **NEW** TAG Solid State SCSI Tape Drive (# TSDT-AXE10-02).

- AXE-10 ODD MODULE WITH AN OLD TAPE DRIVE.



- AXE-10 ODD MODULE WITH A NEW TAG SOLID STATE TAPE DRIVE (# TSDT-AXE10-02).



Ericsson AXE-10 IOG11 Solid State Optical Disk Drive Replacement Procedure

(Applies to Optical Disk Drive Module # ROD 907 32)

1. Remove the AXE-10 ODD Module using standard Ericsson removal procedures.
2. Place the Module on an anti-static surface with the right side facing up.

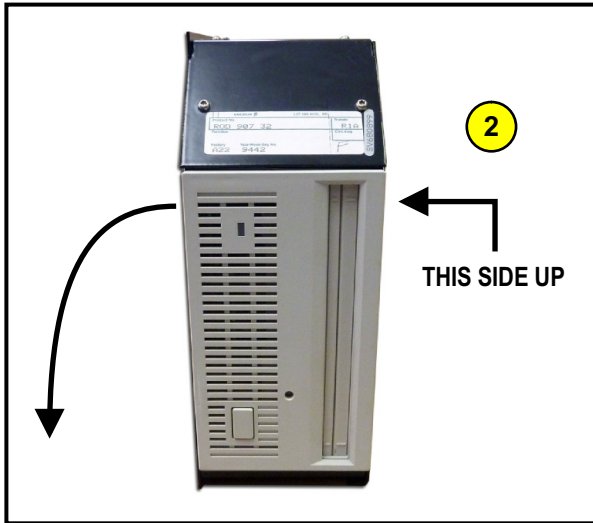

3. Using the supplied TORX screwdriver, remove the (4) screws on the right side of the module as shown.

Set the screws aside for later use.

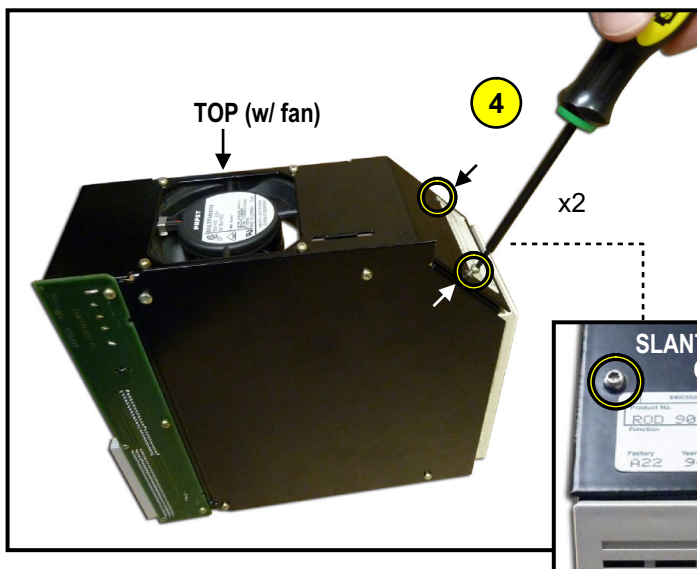
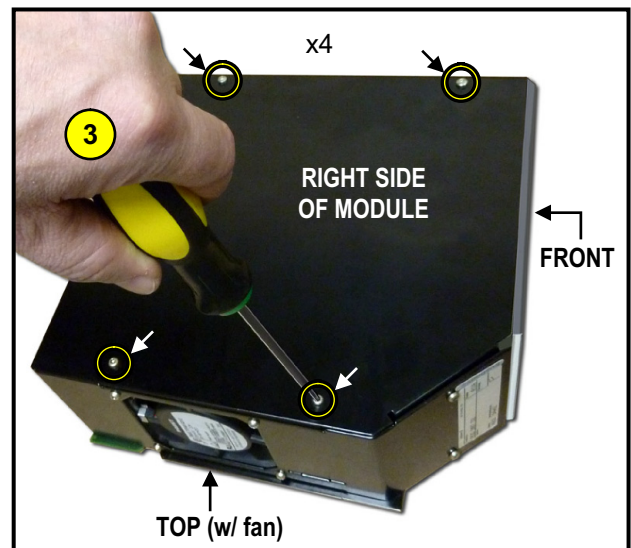

4. Use the TORX screwdriver to remove the (2) screws on the slanted top / front area of the module as shown.

Set the screws aside for later use.

Ericsson AXE-10 IOG11 Solid State Optical Disk Drive Replacement Procedure

(Applies to Optical Disk Drive Module # ROD 907 32)

5. Use the TORX screwdriver to remove the (2) screws on the top of the left side of the module as shown.

Set the screws aside for later use.

Do not remove the (2) screws at the bottom.

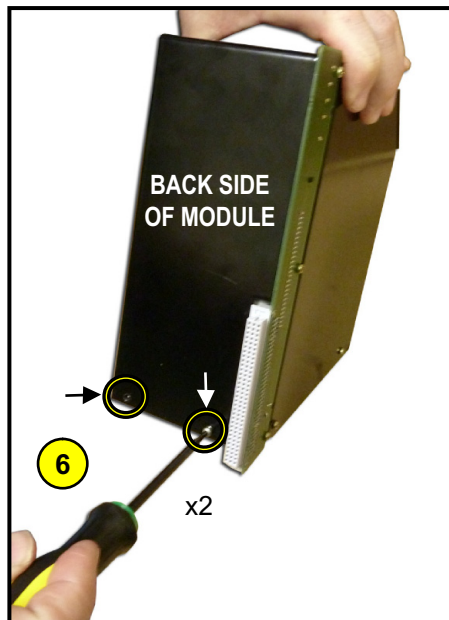
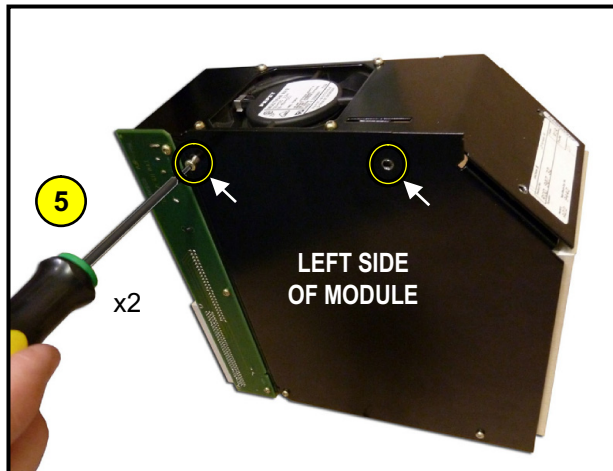

6. Use the TORX screwdriver to remove the (2) screws at the bottom of the back side of the module as shown. *Set the screws aside for later use.*

7. Use the TORX screwdriver to remove the (2) screws on the bottom of the module as shown. *Set the screws aside for later use.*

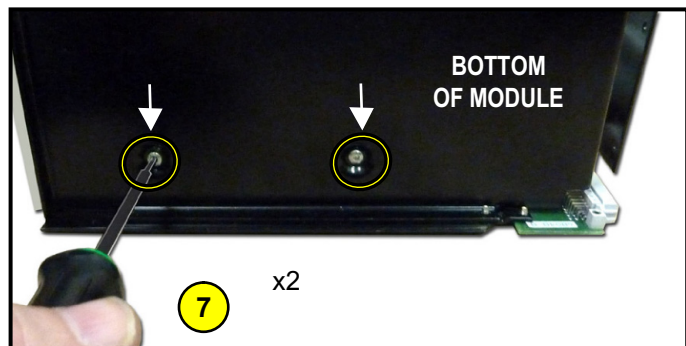

8. Remove the power cable from the defective Drive.*

* *Note: Power cable is seated tightly. Wiggle the connector & pull firmly (avoid pulling on the wires).*

9. Pull the white tab to remove the ribbon cable from the defective Drive.

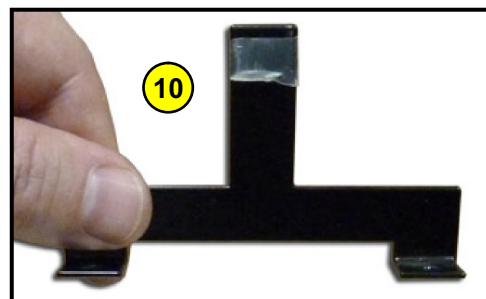
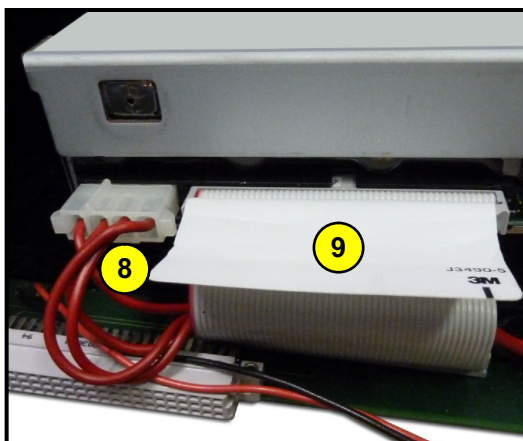

10. Use the TORX screwdriver to remove the (2) screws attaching the black metal bracket to the OLD Drive.

Set the black metal bracket aside for later use.

Place the defective Drive in the appropriate package for return (if needed).

Ericsson AXE-10 IOG11 Solid State Optical Disk Drive Replacement Procedure

(Applies to Optical Disk Drive Module # ROD 907 32)

INSTALL THE NEW TAG TAPE DRIVE

11. Attach the existing black metal bracket to the NEW TAG metal drive assembly.* Using the supplied TORX screwdriver, install the (2) screws as shown.

*Assembly includes the NEW TAG Tape Drive (# TSDT-AXE10-02)

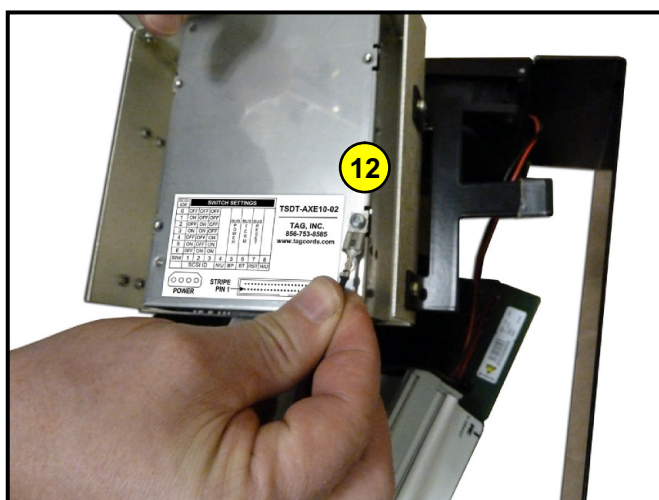
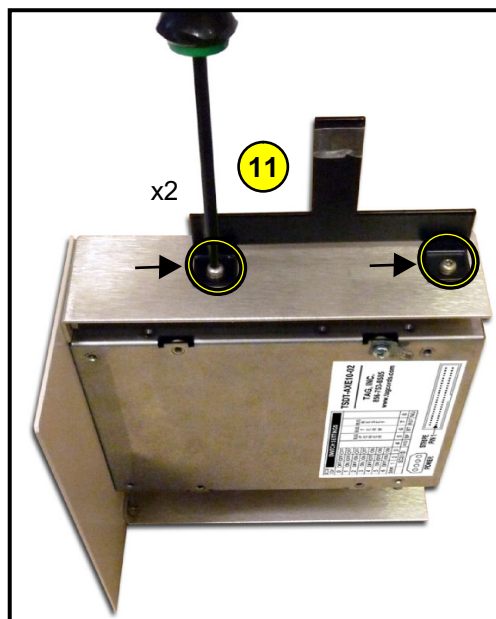

12. Attach the Ground fasten connector to the # TSDT-AXE10-02 as shown.

13. Attach the ribbon cable to the # TSDT-AXE10-02.

14. Attach the power cable to the # TSDT-AXE10-02.



Ericsson AXE-10 IOG11 Solid State Optical Disk Drive Replacement Procedure

(Applies to Optical Disk Drive Module # ROD 907 32)

15. Place the metal drive carrier with the NEW TAG Tape Drive into position on the AXE-10 Module.

16. Use the TORX screwdriver to replace the (2) screws on the bottom of the module as shown below.

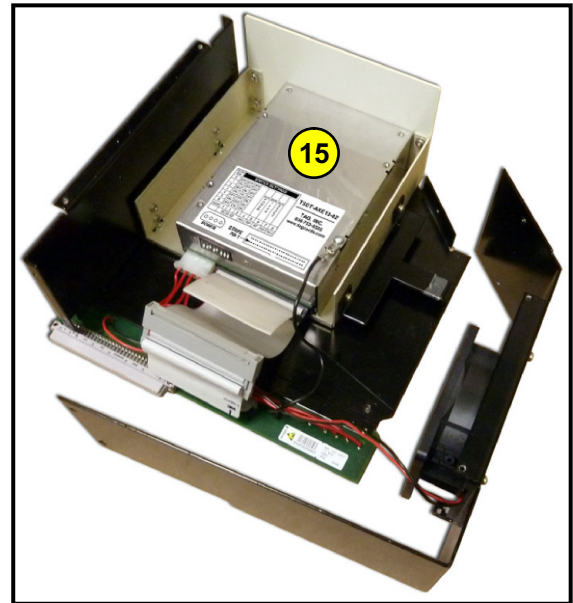
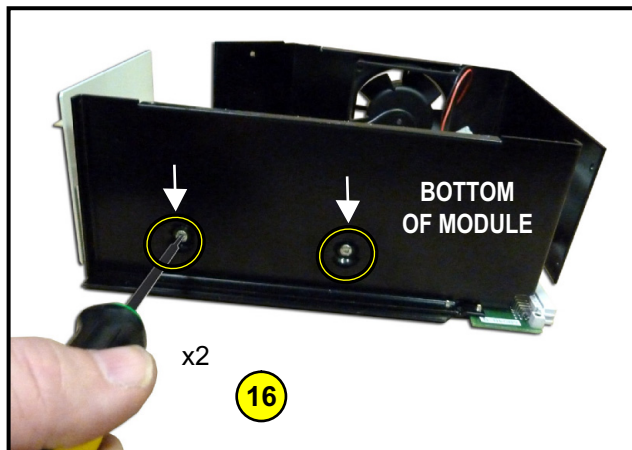

17. Use the TORX screwdriver to replace the (2) screws at the bottom of the back side of the module as shown.

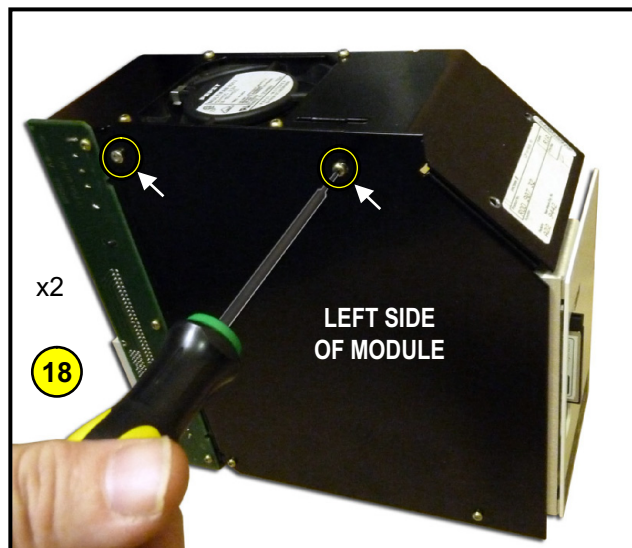
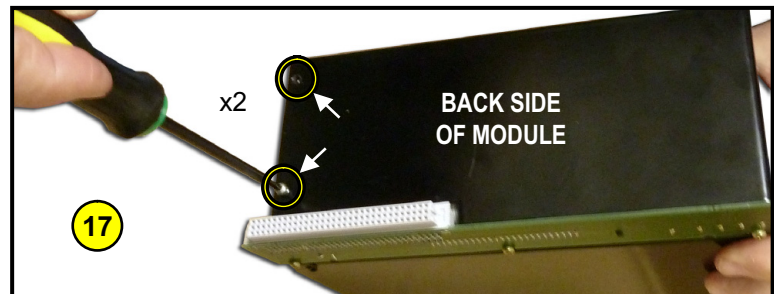

18. Use the TORX screwdriver to replace the (2) screws on the top of the left side of the module as shown.

Ericsson AXE-10 IOG11 Solid State Optical Disk Drive Replacement Procedure

(Applies to Optical Disk Drive Module # ROD 907 32)

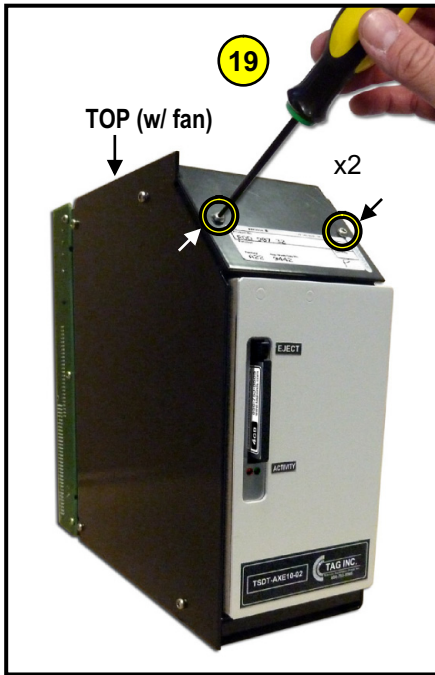

19. Use the TORX screwdriver to replace the (2) screws on the slanted top / front area of the module as shown.

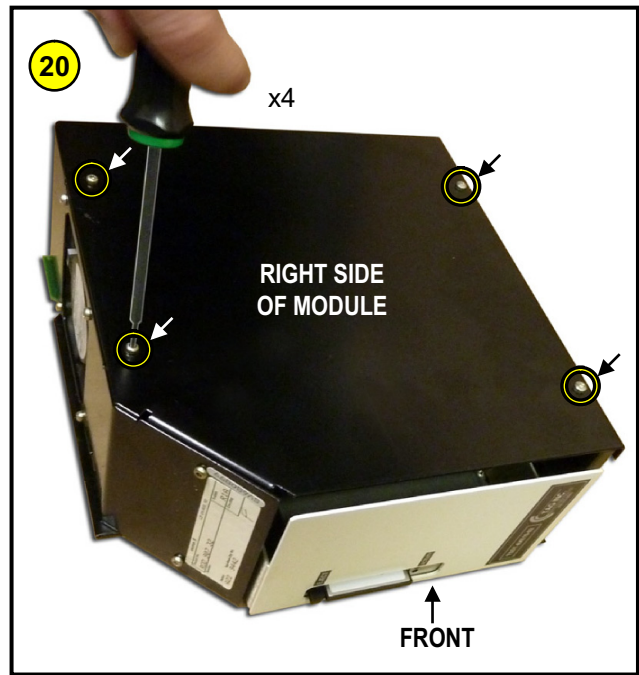

20. Use the TORX screwdriver to replace the (4) screws on the right side of the module as shown.

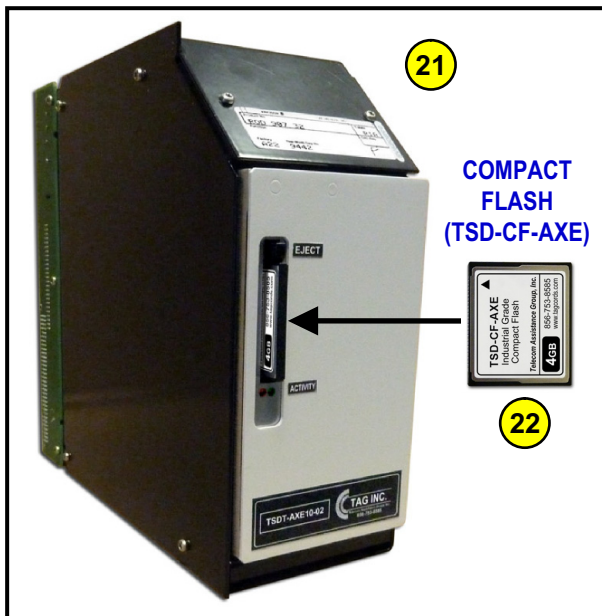

21. Install the AXE-10 Module with the NEW TAG Drive back into the shelf according to Ericsson install & turn up procedures.

22. The TSDT-AXE10-02 includes a TAG Industrial Grade 4GB, AXE formatted Compact Flash Card (PN # TSD-CF-AXE).